

**NOTICE OF PROPRIETARY RIGHTS**

THIS DOCUMENT CONTAINS CONFIDENTIAL TECHNICAL DATA, INCLUDING TRADE SECRETS, PROPRIETARY TO TIMES MICROWAVE SYSTEMS. DISCLOSURE OF THIS DATA IS EXPRESSLY CONDITIONED UPON YOUR ASSENT THAT ITS USE IS LIMITED TO USE WITHIN YOUR COMPANY ONLY. ANY OTHER USE IS STRICTLY PROHIBITED WITHOUT THE PRIOR WRITTEN CONSENT OF TIMES MICROWAVE SYSTEMS.

SD48702

SYM	REVISION DESCRIPTION	DFTM	DATE	APPD	DATE
A	RELEASED FOR PRODUCTION	J. D. B.	3/17/99	J. D. B.	3/17/99
B	CHANGED PER CDC #26495	D. R. W.	2/1/07	J. D. B.	2/6/07
C	CHANGED PER CDC #31272	D. J. H.	2/12/10	J. D. B.	2/12/10

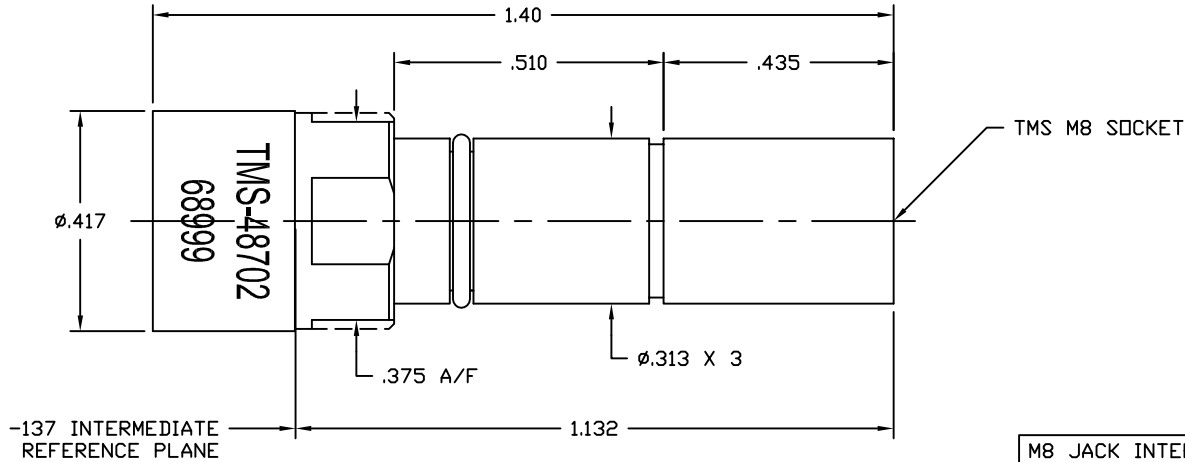

**NOTES:**

1. SPRING AC4048 AND LOCK RING AC4049 ARE SUPPLIED WITH THE CONNECTOR AND ARE NECESSARY TO HOLD THE CONTACT IN THE MULTI-PORT CONNECTOR SHELL. THE SPRING AND THE RING ARE SUPPLIED INSTALLED WITH SPACER AC5090 UNDERNEATH THE SPRING. REMOVE RING, SPRING AND SPACER BEFORE INSTALLING IN SHELL. DISCARD SPACER (AC5090).
2. INSTALLATION TOOL IN-2964 (AC4319) OR IN-2478 (AC4034) IS REQUIRED FOR ASSEMBLY AND REMOVAL OF THE CONNECTOR IN THE MULTI-PORT CONNECTOR SHELL.

AC5090	
AC4048	
AC4049	

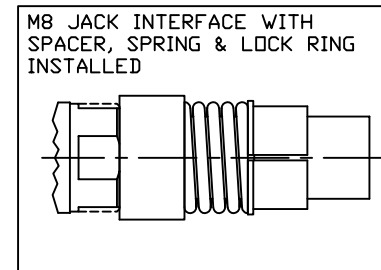

DRAFTSMAN	John D. Bloomfield	3/17/99
CHECKER	John D. Bloomfield	3/17/99
APPROVED	John D. Bloomfield	3/17/99

UNLESS OTHERWISE SPECIFIED  
 ALL DIMENSIONS ARE IN INCHES  
 MACHINED SURFACES FINISH N/A RMS MAX.  
 REMOVE ALL BURRS .005 MAX. BREAK  
 MACHINE CORNERS .005 MAX. FILLET R.  
 TOLERANCES ON DECIMALS  
 .XX ± .03 .XXX ± .005  
 ANGLES ± 1° FRACTIONS ± 1/32  
 DO NOT SCALE DRAWING

011890
W.O. NUMBER
MATERIAL: SEE TABLE

<b>TIMES MICROWAVE SYSTEMS</b>		
TITLE: REPLACEABLE FRONT END -137 TMS M8 SOCKET		
DWG. SIZE <b>B</b>	DRWG. NO. SD48702	REV. C
CODE IDENT. 68999	SCALE: NONE	SHEET: 1 of 1

DIELECTRICS	TEFLON, ASTM D1710	NONE
BODY	BERYLLIUM COPPER, ASTM B196	GOLD PLATE, MIL-G-45204
CONTACT	BERYLLIUM COPPER, ASTM B196	GOLD PLATE, MIL-G-45204
PART NAME	MATERIAL & SPEC. NUMBER	FINISH & SPEC. NUMBER